

# Bada Bing! (behind Left Wire Ramp) Individual Parts Only (Items 1-8B)

| Nr.  | BADA BING! PARTS                    | QTY. | SPI PART Nr. |
|--|-------------------------------------|------|--------------|
| 1  | Bada Bing! Mounting Plate           | 1    | 535-9594-00  |
| Item 1 is secured below the P/F by: #8 X 1/2" SLT HWH AB (Zinc) (Qty. 4) (234-5101-00)   |                                     |      |              |
| 2  | Bushing (White Plastic) 1/4" ø I.D. | 2    | 545-5070-00  |
| Item 2 is secured to Item 1 by: #6-32 X 3/8" SLT HWH Swage (Qty. 3/per) (237-5976-02)  |                                     |      |              |
| 3  | Pulley (1")                         | 2    | 042-5001-01  |
| 4  | Pulley (1-1/2")                     | 1    | 042-5001-02  |
| 5  | Belt (Clear, 10-1/2")               | 1    | 545-6124-04  |
| 6  | Shaft                               | 2    | 530-5691-00  |
| Item 6 is secured to Items 2 & 3 through Items 1 & 2 by: #6-32 X 1/8" Set Screw (Qty. 1/per) (237-5838-03), Washer 1/4" I.D. X 1/2" O.D. X 1/16" Thick (Qty. 1/per @ below plate) (242-5008-00), Washer (Nylon, Plastic) 6/6 MMC 90295A140 (Qty. 1/per @ above plate) (242-5072-01) and Retaining Ring, 1/4" ø (Qty. 2/per above/below plate in grooves) (270-5002-00) |                                     |      |              |

7 Motor Assembly 1 500-6887-00  
**Assembly Parts Included:** Motor 24v AC 4W 50/60Hz 45.7/54.9 RPM Bi-Directional (Qty. 1) (041-5092-00) and 2-Pin Connector (Qty. 1) (045-5004-02) with wiring  
 Item 8 is secured @ top of plate by: #6-32 X 1/4" PPH MS Ext. Sems (Zinc) (Qty. 2) (232-5200-00) and @ bottom of plate into Item 3 by: #6-32 X 1/8" Set Screw (Qty. 1) (237-5838-03)

8A Doll (Black Hair) & Tube Glued Asm. 1 515-7475-01  
 8B Doll (Red Hair) & Tube Glued Asm. 1 515-7475-02  
**Ordering Note:** Doll Hair Color, shape, type and/or position are subject to change and availability. **Assembly Parts Included:** Doll (Black or Red Hair) (Not Available Unglued) (PN REF. 545-6125-01 Black; -02 Red), Tubing (Clear Sleeve) 3/16" O.D. X 5.5" (Qty. 1/per) (605-5017-00) and Plug Spacer (glued in Tube Top) (Qty. 1/per) (605-5017-0P)  
 Items 8A & 8B are secured @ top onto Item 6 by: #4-40 X 1/4" PPH MS Ext. Sems (Zinc) (Qty. 1/per) (237-5909-00) (ASM. REF. 500-6859-00)

For Securing Hardware, see the Parts Table left, under Item desired.

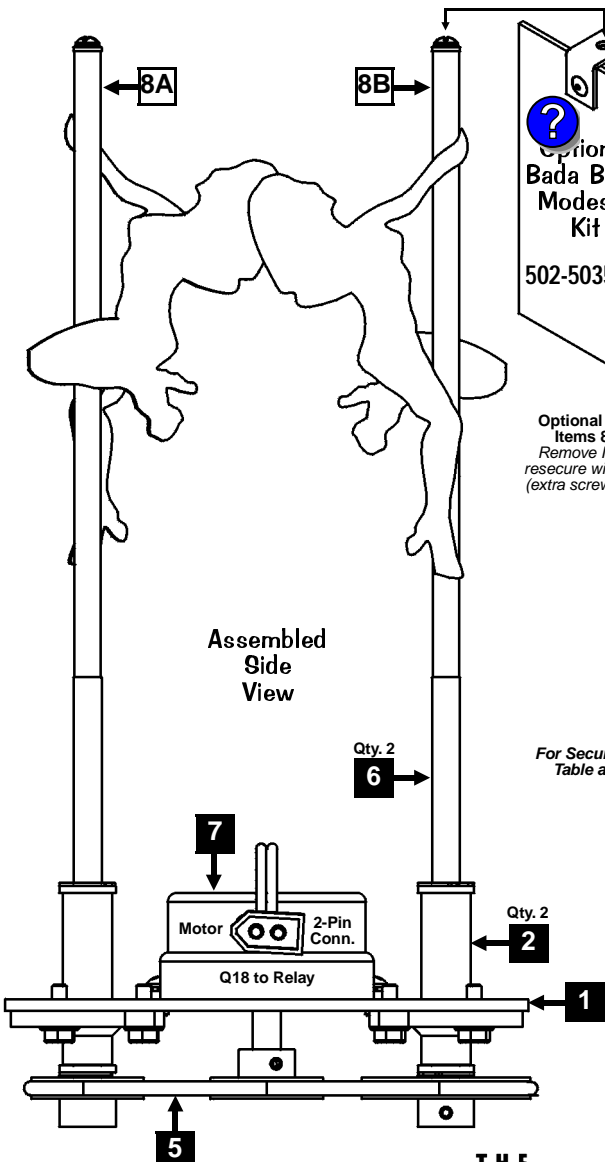
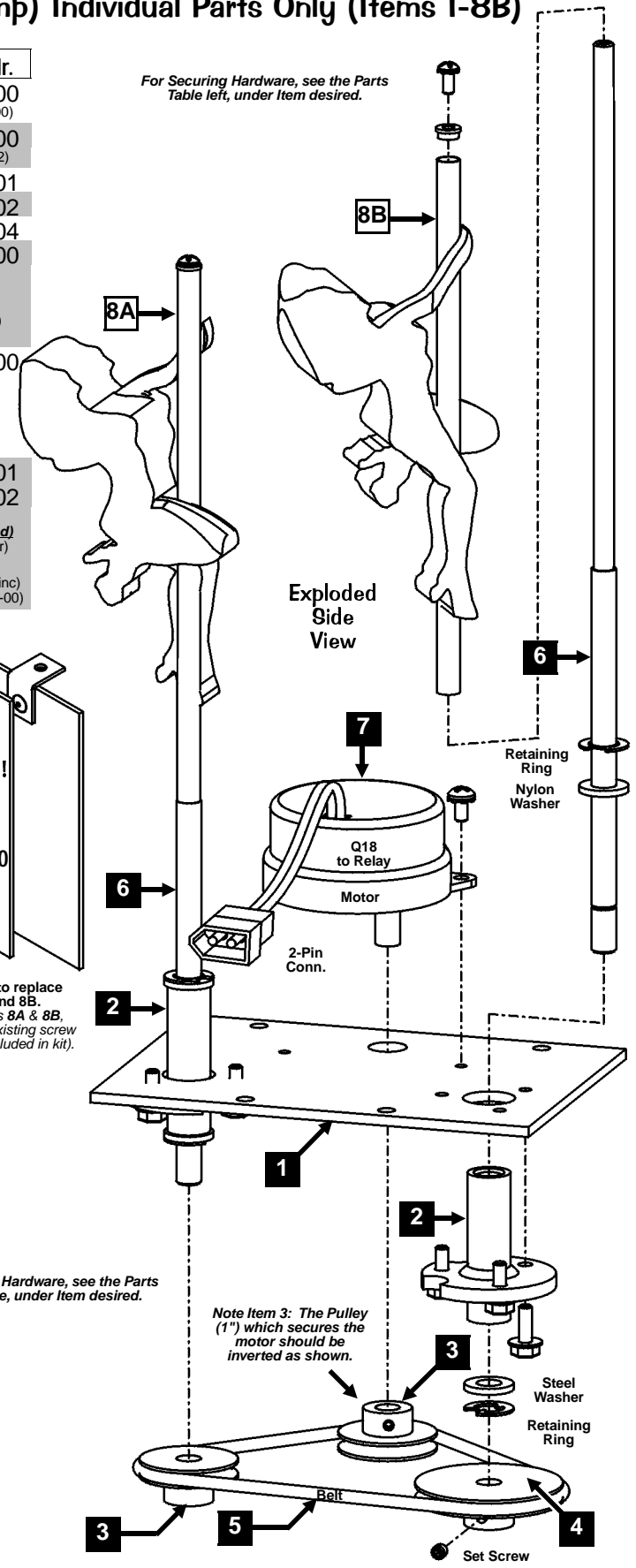

Optional Kit to replace Items 8A and 8B. Remove Items 8A & 8B, resecure with existing screw (extra screw included in kit).

For Securing Hardware, see the Parts Table above, under Item desired.

Note Item 3: The Pulley (1") which secures the motor should be inverted as shown.

Sec. 4: Drawings ...